

Please see also our Tutorial-Videos under www.clue-balance.com – the relevant chapters are marked with this symbol. **VIDEO!**

Before initial operation remove battery-protection slip!

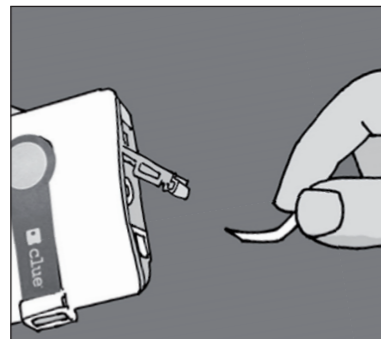

1.

Recording

- Press **clue balance** firm on your sternum and make sure that the 4 electrodes on the back-side of the device have proper skin contact. During recording sit or lie down relaxed!
- By pressing the operating button once the device will be ready.
- The recording will start automatically within 10 seconds. After 2 min. an audible signal confirms the end of the recording. Up to 30 recordings can be stored before transmitting.

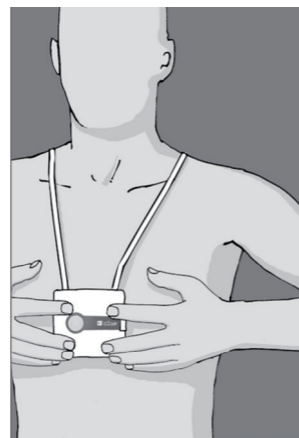

Opening an user-account and activating clue balance

Go to www.clue-balance.com

- Click on LOGIN under "Service Center Login". Click on "Create a new account". Fill in under "Account Information" a selected user name and choose a password, which has to consist of at least 8 characters and thereby of at least one uppercase letter, one lowercase letter, and one numeric character.
- Register the **clue balance** device under "Device Information" by filling in under "Device S/N" the serial number digits (see S/N on the backside of Instruction Manual).
- Fill in under "Activation Code" the relevant Activation Code(see on the backside of Instruction Manual) and click on "Create account"

2.

Transmitting recordings to online service center

- Prior to transmitting recordings via PC/Laptop the utility program **clueSync** has to be installed on the PC/Laptop, see www.clue-balance.com under "Download".
- Plug enclosed USB-Infrared-Stick in a free USB jack on the PC/Laptop and the installation starts automatically, otherwise with the enclosed Mini-Driver-CD.
- Set the DIP switches (left side of battery compartment): Left DIP switch has to be up and the right DIP switch has to be down. **VIDEO!**

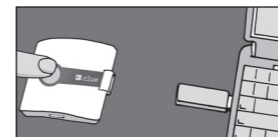

Position **clue balance** around 10 cm from the USB-Infrared Stick (Infrared window of **clue balance** has to face the USB-Infrared Stick). Now press the operating button once to switch on and a second time to start transmission.

Successful transmission is confirmed by audible signal!

3.

Overview of Device / Operating Elements

- 1 Operating button
- 2-4 LEDs
- 5 Infrared window
- 6 Connection socket for electrode cable

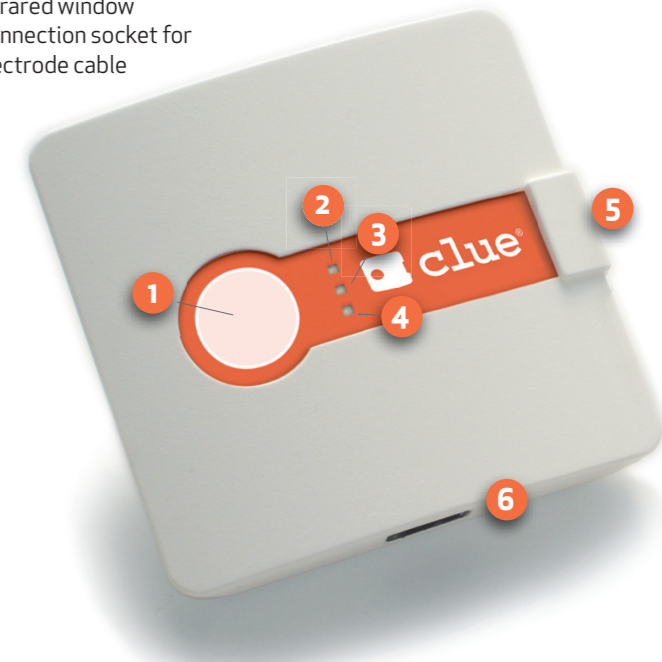

Overview of Device / Operating Elements

- 7 Battery compartment cover with DIP switches for changing transmission mode
- 8 Fixed electrodes

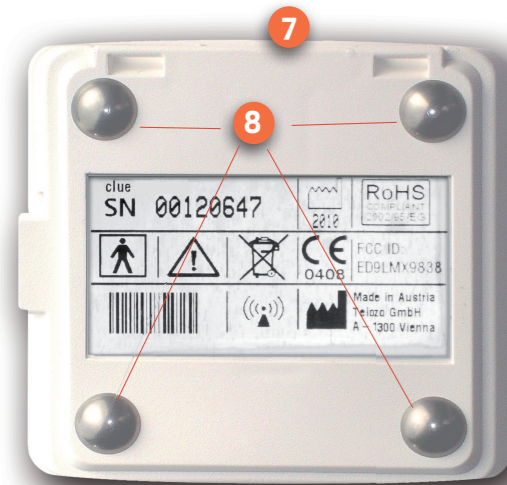

4.

Remote access to recordings on the online service center

- Click on "LOGIN" on our homepage. **VIDEO!**
- Fill in username and password, where required also language.
- The list of various recordings of one or more **clue balance** devices will be displayed.
- Click on the selected recording (first column, under #). Select under "ECG Details" at "Data" the PDF sign for a graphic presentation.

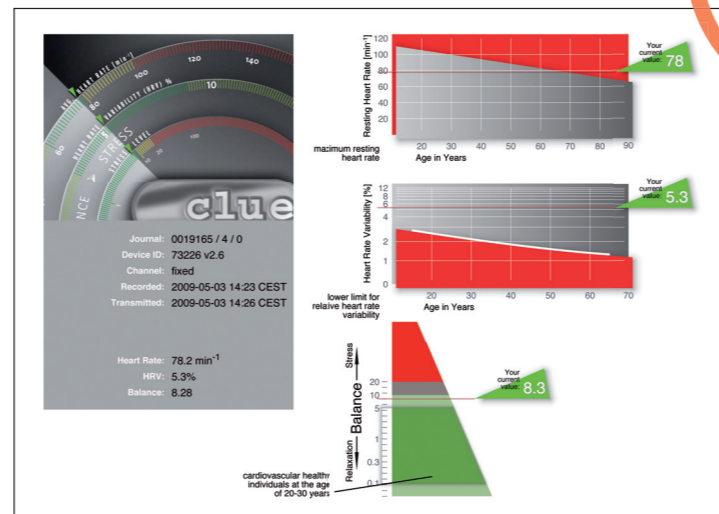

Alternatively direct transmission of recording(s) to your PC/Laptop – without involvement of online service center and without remote access

- Both DIP switches (left of battery compartment) have to be in position down. **VIDEO!**
- USB-Infrared-Stick has to be installed (see chapter 3)
- Press operating button once to switch the device on and press it a second time to start transmitting. Confirm question of accepting the transmission with "YES".
- Successful transmission of the relevant presentation as PDF is displayed on the desktop after being clicked on the PDF sign. (the desktop PDF sign includes the **clue balance** device number, together with a serial recording number).

Brief Operating Instructions clue balance

 clue

